

Safety switch with separate actuator

AZ 17

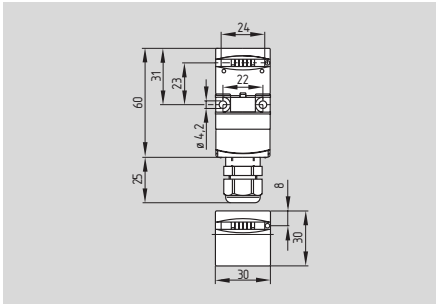

- Thermoplastic enclosure
- Small body
- Multiple coding
- Individual coding available on request
- Long life
- Double insulated
- Including cable gland M16
- Slot sealing plug included
- High level of contact reliability with low voltages and currents
- Not sensitive to dirty conditions by virtue of patented roller system
- 8 actuating planes
- Insulation displacement connector

Technical data

Standards: IEC/EN 60947-5-1
BG-GS-ET-15

Enclosure: glass-fibre reinforced thermoplastic, self-extinguishing

Actuator: stainless steel 1.4301

Protection class: IP 67 to EN 60529

Contact material: silver

Contact type: change-over contact with double break, type Zb or 2 NC contacts, with galvanically separated contact bridges

Switching system: \ominus IEC 60947-5-1 slow action, NC contact with positive break

Termination: cut clamp terminals (IDC method)

Cable section: 0.75 – 1.0 mm², flexible

U_{imp} : 4 kV

U_i : 250 V

I_{the} : 10 A

Utilisation category: AC-15

I_e/U_e : 4 A / 230 VAC

Max. fuse rating: 6 A gL/gG D-fuse

Positive break travel: 11 mm

Positive break force: 17 N for each NC contact fitted

Ambient temperature: – 30 °C ... + 80 °C

Mechanical life: > 1 million operations

Latching force: 30 N for ordering suffix r

Contact variants

1 NO / 1 NC



2 NC



Connector

1 NO / 1 NC

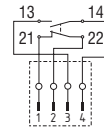

2 NC

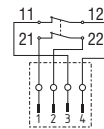

Front cable output

1 NO / 1 NC

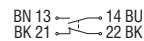

2 NC



Rear cable output

1 NO / 1 NC

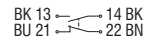

2 NC



Approvals



Ordering details

AZ 17-①z②k-③-④-⑤

No.	Replace	Description
①	11	1 NO / 1 NC
	02	2 NC
②	r	Latching force 5 N
		Latching force 30 N
③		Cable gland M16
	2243	Cable output front
	2243-1	rear
	ST	Connector M12
④	1637	Gold-plated contacts
⑤	5m	Cable length 5 m
	6m	Cable length 6 m

Note

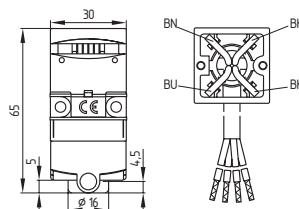

- Front cable output, ordering suffix -2243
- Rear cable output, ordering suffix -2243-1

Note

Actuators must be ordered separately.

Safety switch with separate actuator

System components

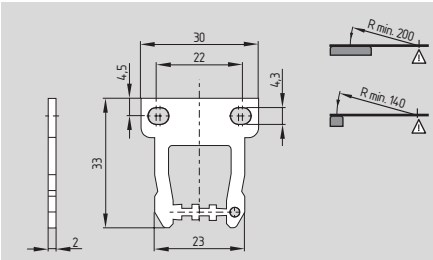

Straight actuator AZ 17/170-B1

System components

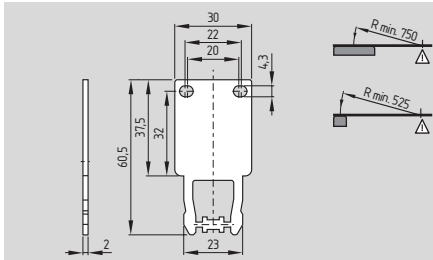

Long straight actuator AZ 17/170-B11

System components

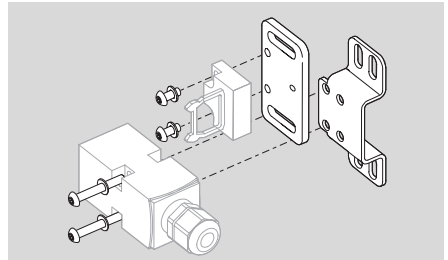

Mounting set MS AZ 17

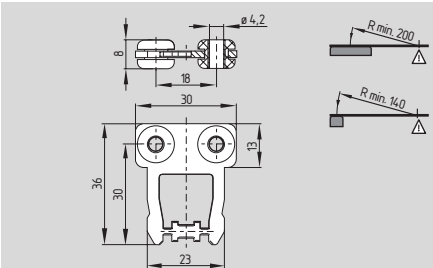

With rubber mounting AZ 17/170-B1-2245

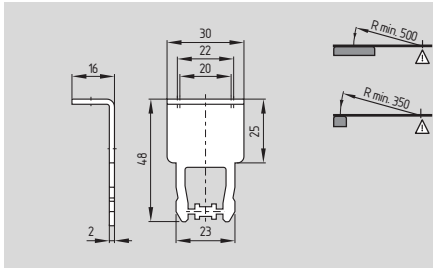

Long angled actuator AZ 17/170-B15



Connector plug M 12 x 1

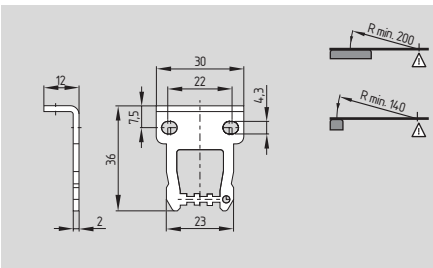

Angled actuator AZ 17/170-B5



Connector plug M 12 x 1 (with cable)

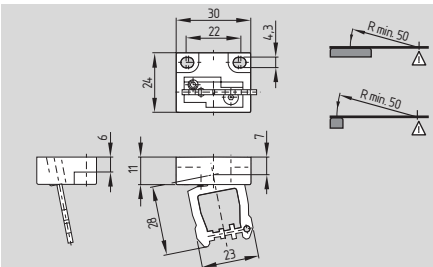

Flexible actuator AZ 17-B6



Tamperproof screws

Ordering details

Straight actuator **AZ 17/170-B1**
 with rubber mounting **AZ 17/170-B1-2245**
 Angled actuator **AZ 17/170-B5**
 Flexible actuator **AZ 17-B6**

Ordering details

Long straight actuator **AZ 17/170-B11**
 Long angled actuator **AZ 17/170-B15**

Ordering details

Mounting set **MS AZ 17**
 Connector plug M 12 x 1 **1093038**
 Connector plug M 12 x 1 (with cable) **1148412**
 Tamperproof screws with unidirectional slots M4 x 8 (Quantity 2 pcs) **1147463**