

# Safety switch with separate actuator

## AZ 15

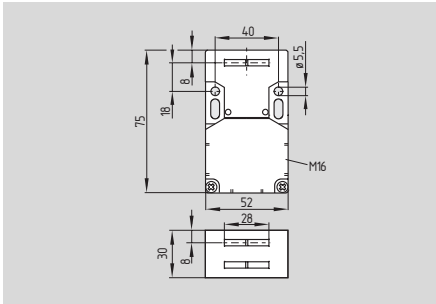

- Long life
- Multiple coding
- Thermoplastic enclosure
- Double insulated
- 3 cable entries M16 x 1.5
- Large wiring compartment
- High level of contact reliability with low voltages and currents
- Not sensitive to dirty conditions by virtue of patented roller system
- Slotted holes for adjustment, circular holes for location

## Technical data

Standards: IEC/EN 60947-5-1  
BG-GS-ET-15

Enclosure: glass-fibre reinforced thermoplastic, self-extinguishing

Actuator: stainless steel 1.4301

Protection class: IP 67 to EN 60529

Contact material: silver

Contact type: 1 NC contact

Switching system:  $\ominus$  IEC 60947-5-1  
slow action,  
NC contact with positive break

Termination: screw terminals

Cable section: max. 2.5 mm<sup>2</sup>  
(incl. conductor ferrules)

Cable entry: 3 x M16 x 1.5

$U_{imp}$ : 6 kV

$U_i$ : 500 V

$I_{the}$ : 10 A

Utilisation category: AC-15, DC-13

$I_e/U_e$ : 4 A / 230 VAC  
4 A / 24 VDC

Max. fuse rating: 6 A gL/gG D-fuse

Positive break travel: 8 mm

Positive break force: 10 N for each  
NC contact fitted

Ambient temperature: - 30 °C ... + 80 °C

Mechanical life: > 1 million operations

Latching force: 30 N for ordering suffix r

## Contact variants

**1 NC**

**Connector**  
**1 NC**

## Approvals



## Ordering details

AZ15-zv<sup>①</sup>k-<sup>②</sup>-<sup>③</sup>

No.	Replace	Description
①	r	Ejection force Latching force 30 N
②	ST	Cable entry M 16 Connector M 12 x 1
③	2254	Latching force 5 N
	1762	Front mounting
	1637	Gold-plated contacts

## Note

Actuators must be ordered separately.

# Safety switch with separate actuator

## System components

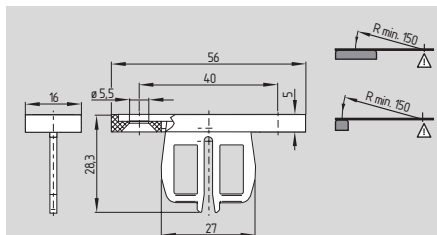

**Straight actuator AZ 15/16-B1**

## System components

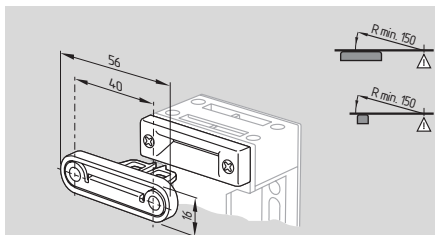

**AZ 15/16-B1-2177 with centering guide**

## System components

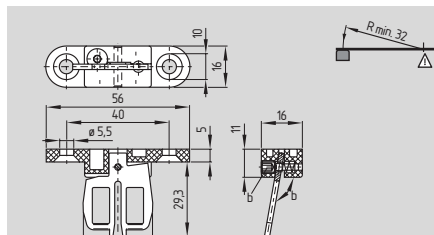

**Flexible actuator AZ 15/16-B3**



**AZ 15/16-B1-1747 with magnetic latch**

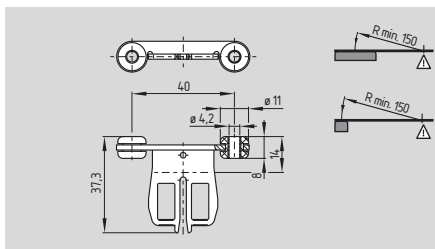

**AZ 15/16-B1-2245 with rubber mounting**

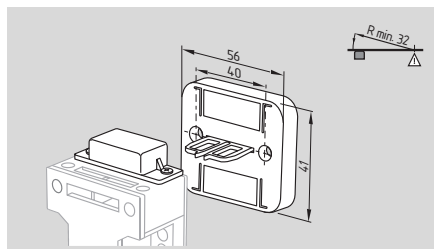

**AZ 15/16-B3-1747 with magnetic latch**

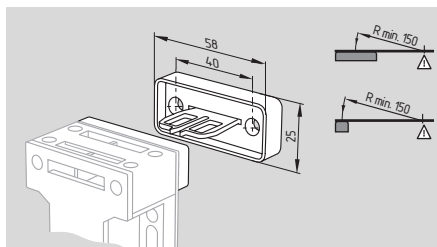

**AZ 15/16-B1-2024 with slot lip-seal**

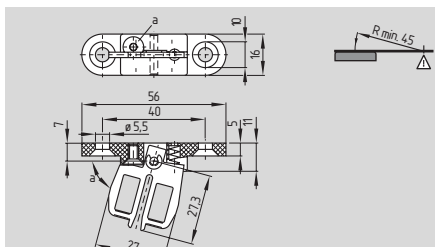

**Flexible actuator AZ 15/16-B2**

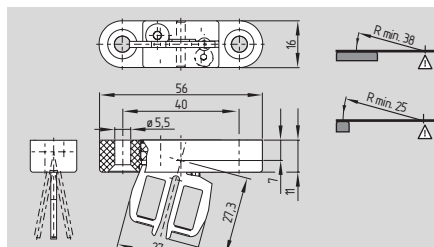

**Flexible actuator AZ 15/16-B6**

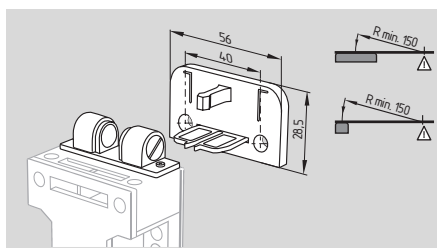

**AZ 15/16-B1-2053 with ball latch**

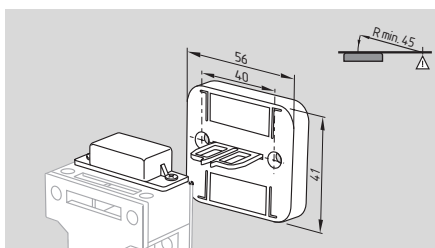

**AZ 15/16-B2-1747 with magnetic latch**

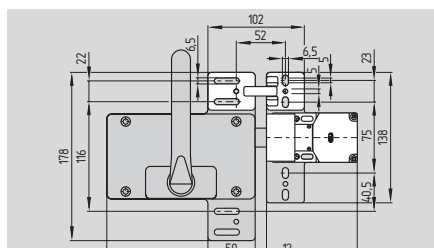

**Actuator AZ 16-B30**

## Ordering details

Straight actuator  
with magnetic latch  
with slot lip-seal  
with ball latch

**AZ 15/16-B1**  
**AZ 15/16-B1-1747**  
**AZ 15/16-B1-2024**  
**AZ 15/16-B1-2053**

Straight actuator  
with centering guide  
with rubber mounting  
Flexible actuator  
with magnetic latch

**AZ 15/16-B1-2177**  
**AZ 15/16-B1-2245**  
**AZ 15/16-B2**  
**AZ 15/16-B2-1747**

## Ordering details

Flexible actuator  
with magnetic latch  
Flexible actuator

**AZ 15/16-B3**  
**AZ 15/16-B3-1747**  
**AZ 15/16-B6**

Actuator with or without  
emergency handle

**AZ 16-B30**

A detailed product description can  
be found in the „Safety door handle  
system STS“ brochure.

## Safety switch with separate actuator

### System components

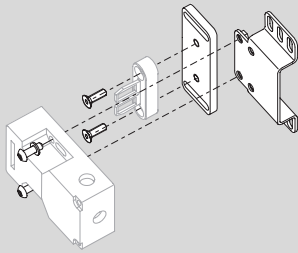

Mounting set MS AZ 15/16

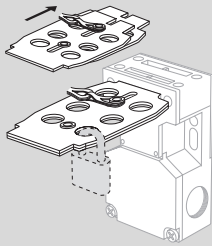

Lockout tag SZ 16/335

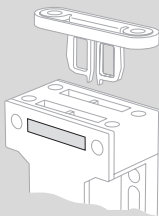

Slot sealing plug AZ 15/16-1476

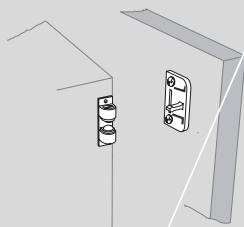

Ball catch 2053-2

### System components

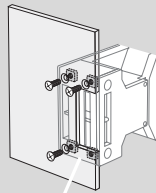

### Ordering details

Mounting set	<b>MS AZ 15/16</b>
Lockout tag	<b>SZ 16/335</b>
Slot sealing plug	<b>AZ 15/16-1476</b>
Ball catch	<b>-2053-2</b>